

1518 N STANLEY AVENUE, LOS ANGELES, CA, US, 90046

https://realtorjd.com

1518 N Stanley Avenue, Los Angeles, CA, US, 90046

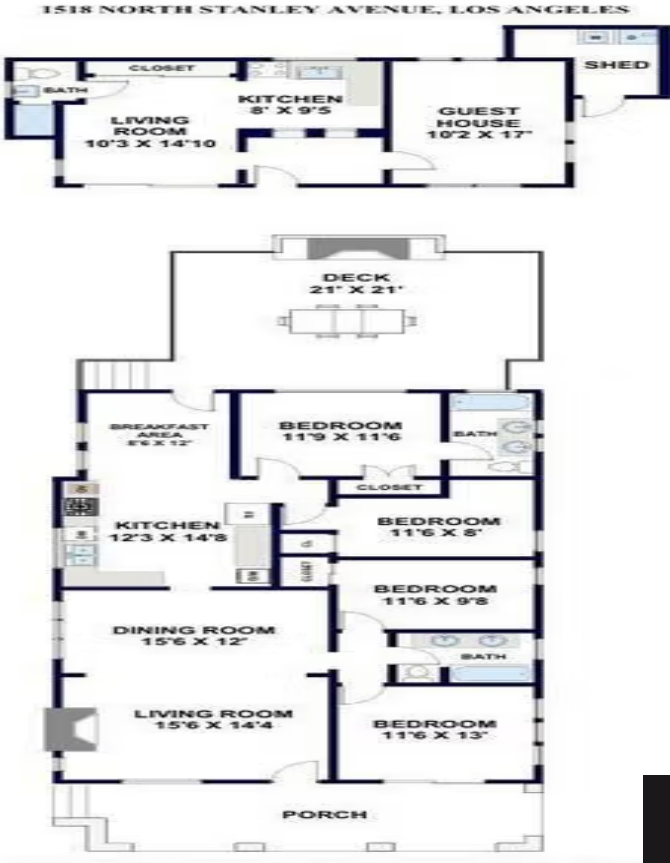

\$1,799,000

Sunset Square Spanish Hedged + Gated Retreat with lush landscaping, 4 beds + 2 baths in the main house & [...]



The Bienstock Group

- 5 beds
- 3 baths
- SingleFamilyResidence
- Residential
- Active
- 2112 sq ft

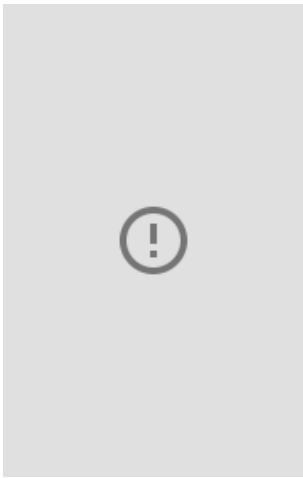

Basics

Category: Residential

Status: Active

Bathrooms: 3 baths

Lot size: 5399, 5399 sq ft

View: None

County: Los Angeles

Type: SingleFamilyResidence

Bedrooms: 5 beds

Area: 2112 sq ft

Year built: 1920

Zoning: LAR1

Building Details

Architectural Style: Spanish

Common Walls: NoCommonWalls

Other Structures: GuestHouse

Open Parking Spaces: 2

Levels: One

Floor covering: Tile, Wood

Amenities & Features

Pool Features: None

Spa Features: None

Cooling: CentralAir

Furnished: Unfurnished

Laundry Features: InKitchen

Parking Features: Driveway

Parking Total: 2

Fireplace Features: Decorative, LivingRoom, Outside

Heating: Central

Appliances: Dishwasher,Refrigerator,Dryer,Washer

Nearby Schools

High School District: Los Angeles Unified

Agent info



Agent name: Sheri Bienstock

Agent MLS: CLW-X76580

Agent email: hello@TheBienstockGroup.com

Agent direct phone: 323-310-2525

Miscellaneous

List Office Name: The Bienstock Group

Direction Faces: West

