

3019 HILDRETH COURT, LANCASTER, CA, US, 93535

https://realtorjd.com

3019 Hildreth Court, Lancaster, CA, US, 93535

3019 Hildreth Ct, Lancaster, CA 93535

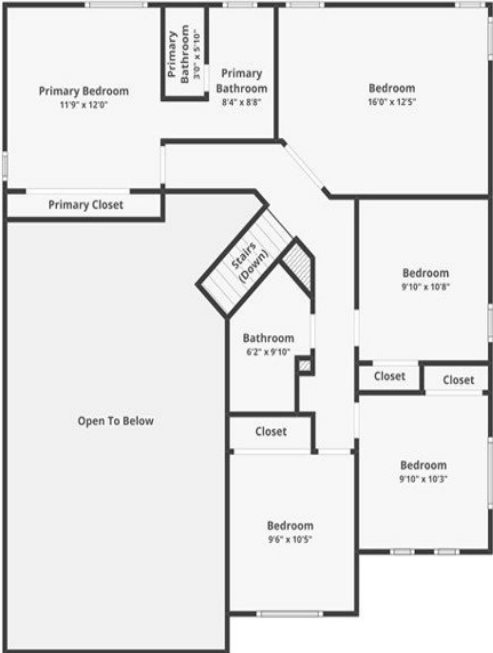

Floor 2

\$489,000

Floor plans are for informational purposes only and not for construction or design use. Measurements are approximate, and square footage may include fireplaces.

Welcome to the home you've been waiting for—perfectly situated at the end of a quiet cul-de-sac on a beautiful tree-lined [...]



Equity Union

- 4 beds
- 3 baths
- SingleFamilyResidence
- Residential
- Active
- 1756 sq ft

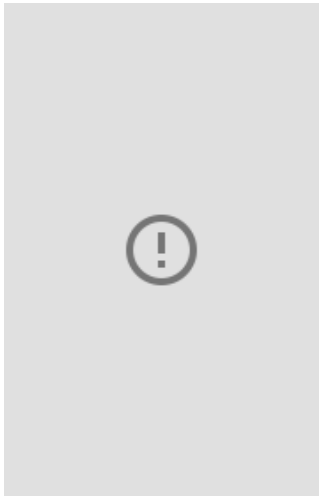

Basics

Category: Residential

Status: Active

Bathrooms: 3 baths

Lot size: 7708, 7708 sq ft

View: None

Type: SingleFamilyResidence

Bedrooms: 4 beds

Area: 1756 sq ft

Year built: 1992

County: Los Angeles

Building Details

Structure Type: House

Lot Features:

CulDeSac,FrontYard,SprinklersInRear,SprinklersInFront,NearPark

Common Walls: NoCommonWalls

Levels: Two

Water Source: Public

Sewer:

PublicSewer,SewerTapPaid

Garage Spaces: 3

Floor covering: Carpet,
Tile, Vinyl

Amenities & Features

Pool Features: None

Patio & Porch Features:

FrontPorch

Cooling: CentralAir

Heating: Central

Laundry Features: InGarage

Parking Features: Garage, RvGated

Parking Total: 3

Fireplace Features: FamilyRoom

Interior Features: CathedralCeilings, EatInKitchen,
GraniteCounters, HighCeilings, OpenFloorplan,
RecessedLighting, AllBedroomsUp

Appliances: GasOven

Nearby Schools

High School District: Lancaster



Agent info

Agent name: Ryan Arditty

Agent email: ryanarditty@gmail.com

Agent direct phone: 661-857-1013

Agent MLS: F207099794

Agent officephone: 661-516-2064

Miscellaneous

List Office Name:
Equity Union

Listing Terms: CashToNewLoan,Conventional,CalVetLoan,FHA,VaLoan

Common Interest:
None

Community Features:
Curbs,Hiking,StormDrains,StreetLights,Sidewalks,Park

Attribution Contact:
661-857-1013

